

**MAINTENANCE FACILITY - GROUND FLOOR PLAN**  
SCALE 1:200

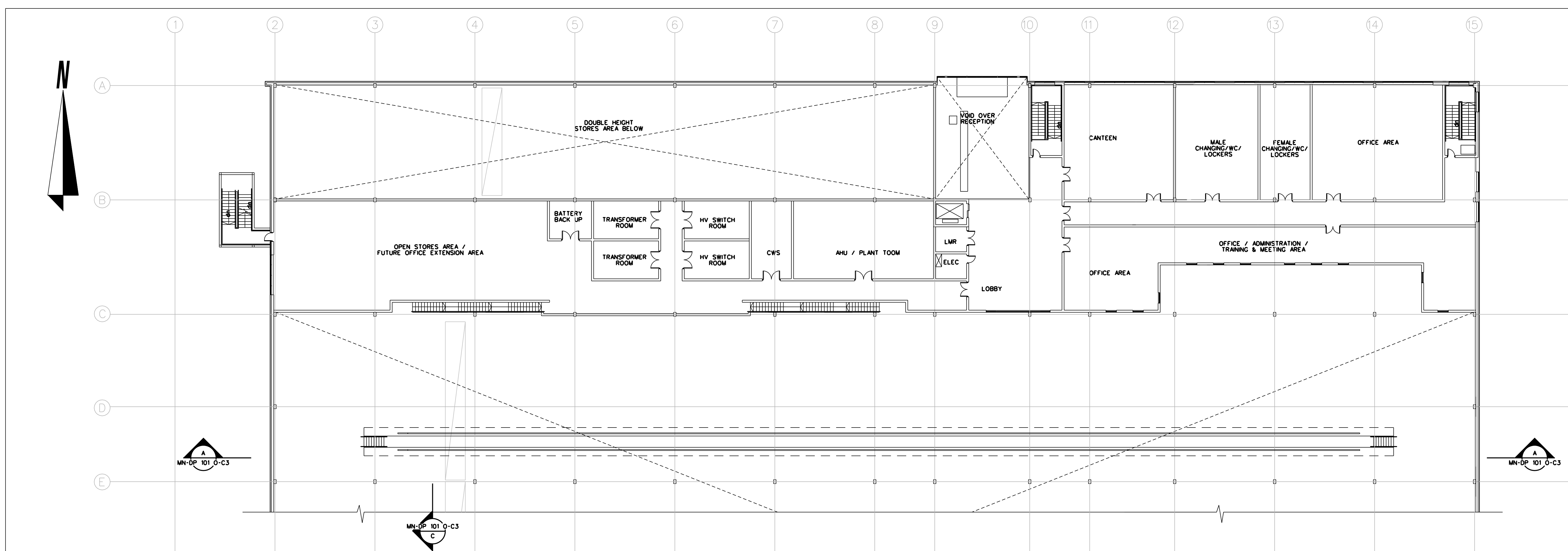

**MAINTENANCE FACILITY - PART FIRST FLOOR PLAN**  
SCALE 1:200

REFERENCE RELATED DRAWINGS  
 FOR 1:500 TRACK ALIGNMENT DRAWINGS SEE  
 RAIL ORDER PLAN No's.  
 MN-RO 101 0-AL/MN/000/GA/101001/A)  
 MN-RO 101 A-BL/MN/000/GA/101002/A)  
 MN-RO 101 B-C/L/MN/000/GA/101003/A)

FOR LOCATION OF MAINTENANCE FACILITY BUILDING SEE  
 PLAN No. MN-DP 101 0-C1(L/MN/000/DB/101001/A)  
 AND FOR ELEVATIONS AND SECTIONS SEE PLAN No.  
 MN-DP 101 0-C3(L/MN/000/DB/101003/A)

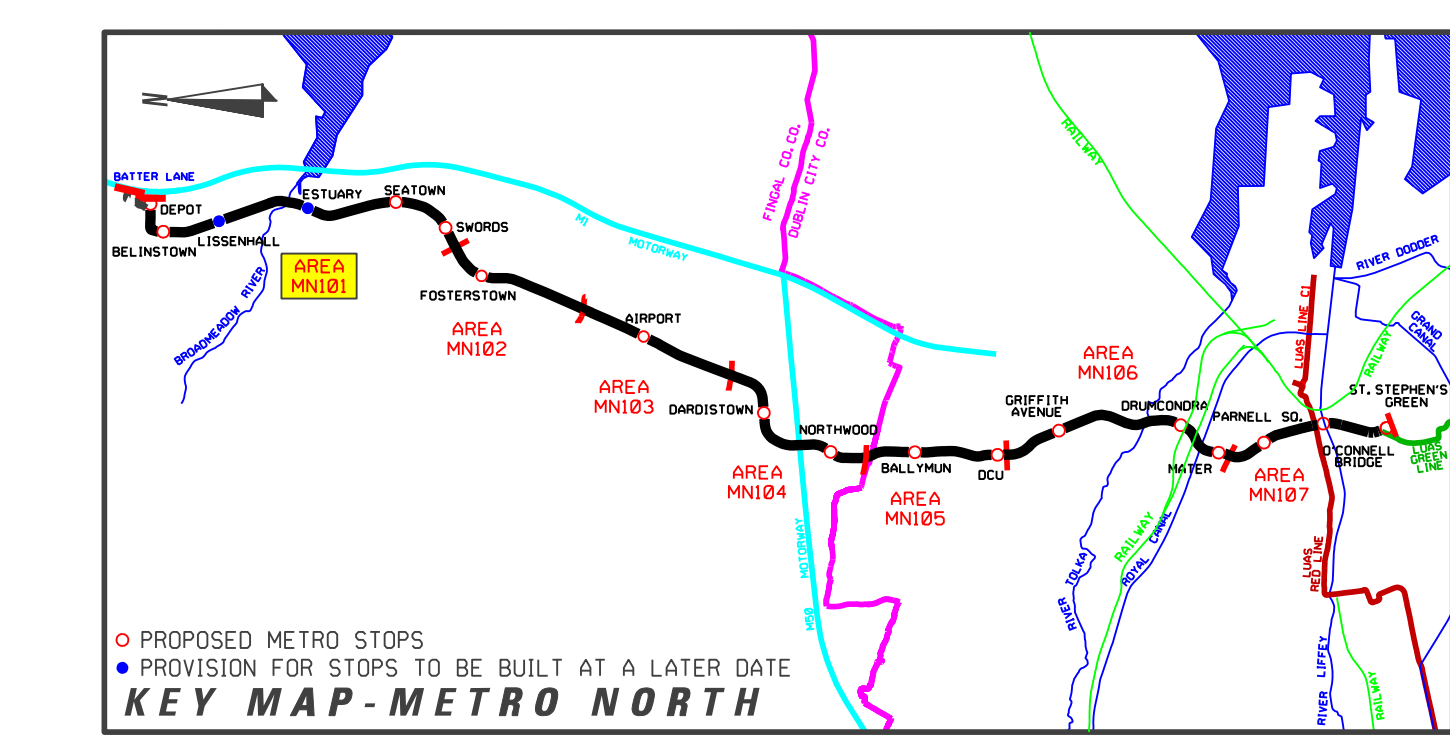

REVISION	DATE	MODIFICATION	STATUS	CHECKED/APPROVED

 Railway Procurement Agency		<b>TITLE:</b> <b>RAILWAY WORKS</b> <b>LINE MN - STRUCTURES</b> <b>DEPOT - MAINTENANCE FACILITY PLANS</b>	
		PREPARED: RPA OFFICE SCALE: 1:200 DATE: AUGUST 2008	CHECKED: GEOFFREY FEATHERSTONE APPROVED: ROBY O'CONNOR
AREA NO. <b>101</b>	PLAN NO. <b>MN-DP 101 0-C2</b>	SUBJECT: <b>RAIL ORDER</b>	

©Copyright Railway Procurement Agency  
 This drawing is confidential and the copyright is owned by the RPA. This drawing must not be either loaned,  
 copied or otherwise reproduced in whole or in part without the prior permission of the RPA.  
 All U.S. data used for plans is generated from U.S. digital data and are printed under Ordnance Survey permit no. 05.8817

INTERNAL DOCUMENT NUMBER	STAGE	LINE	CONTRACT	ELEMENT	DRW NO	DRW REV
	L	MN	000	DB	101002	A